

Lasnek

STAINLESS STEEL COMPACT ENCLOSURES



- Stainless Grade 304 / 1.4301
- Material Thickness 1.2/1.5mm
- Satin Brush Finish
- Pin Lock(s) & Key
- Bespoke Service Available
- IP65
- BS EN60529:1992
- Concealed Hinges
- Galvanized Backplate
- Same Day despatch

COMPACT ENCLOSURES TECHNICAL DATA

KCC-01 TO KCC-05 CABINET DIMENSIONS

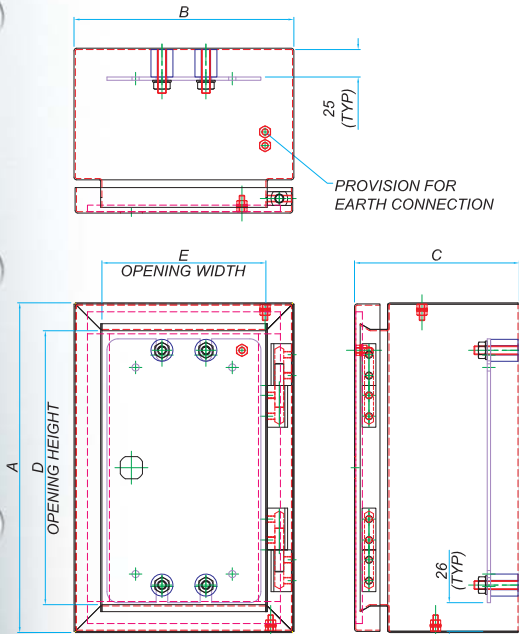

| | A | B | C | D | E |
|--------|-----|-----|-----|-----|-----|
| KCC-01 | 300 | 200 | 150 | 249 | 149 |
| KCC-02 | 300 | 300 | 150 | 249 | 249 |
| KCC-03 | 450 | 200 | 200 | 399 | 149 |
| KCC-04 | 450 | 300 | 200 | 399 | 249 |
| KCC-05 | 450 | 450 | 200 | 399 | 399 |

NOTE: HINGED ON THE RIGHT UNLESS OTHERWISE STATED, CUT OUTS MAY HIND THE ENCLOSURE.
NOTE: ALL DIMS ARE IN mm WITH A TOLARENCE +/- 2mm

KCC-06 TO KCC-14 CABINET DIMENSIONS

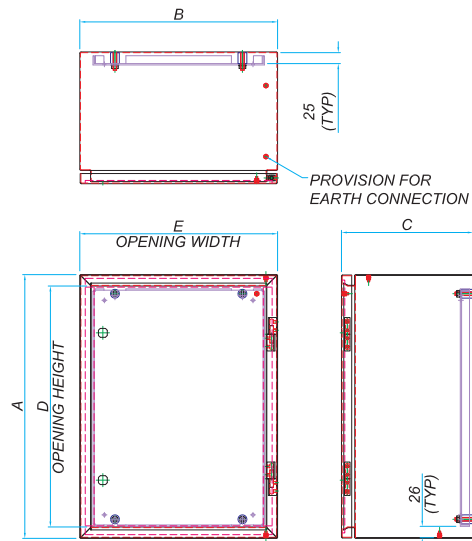

| | A | B | C | D | E |
|--------|------|------|-----|-----|-----|
| KCC-06 | 600 | 300 | 300 | 548 | 248 |
| KCC-07 | 600 | 450 | 300 | 548 | 398 |
| KCC-08 | 600 | 600 | 300 | 548 | 548 |
| KCC-09 | 750 | 450 | 300 | 698 | 398 |
| KCC-10 | 750 | 600 | 300 | 698 | 548 |
| KCC-11 | 750 | 750 | 300 | 698 | 698 |
| KCC-12 | 1000 | 500 | 300 | 948 | 448 |
| KCC-13 | 1000 | 750 | 300 | 948 | 698 |
| KCC-14 | 1000 | 1000 | 300 | 948 | 948 |

NOTE: HINGED ON THE RIGHT UNLESS OTHERWISE STATED, CUT OUTS MAY HIND THE ENCLOSURE.
NOTE: ALL DIMS ARE IN mm WITH A TOLARENCE +/- 2mm

KCC-01 TO KCC-06 BACKPLATE DIMENSIONS

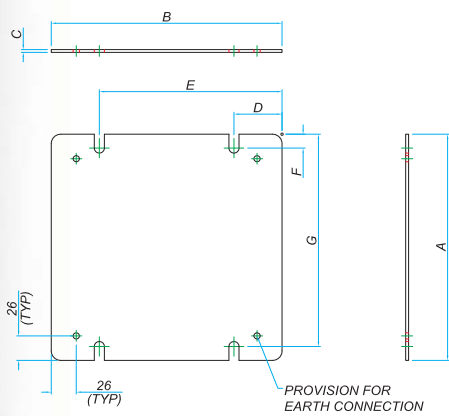

| | A | B | C | D | E | F | G |
|--------|-----|-----|---|----|-----|----|-----|
| KCC-01 | 240 | 140 | 3 | 50 | 90 | 15 | 225 |
| KCC-02 | 240 | 240 | 3 | 50 | 190 | 15 | 225 |
| KCC-03 | 390 | 140 | 3 | 50 | 90 | 15 | 375 |
| KCC-04 | 390 | 240 | 3 | 50 | 190 | 15 | 375 |
| KCC-05 | 390 | 390 | 3 | 50 | 340 | 15 | 375 |
| KCC-06 | 540 | 240 | 3 | 50 | 190 | 15 | 525 |

NOTE: ALL DIMS ARE IN mm WITH A TOLARENCE +/- 2mm

KCC-07 TO KCC-14 BACKPLATE DIMENSIONS

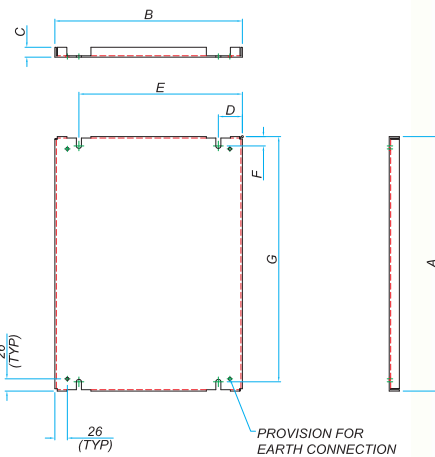

| | A | B | C | D | E | F | G |
|--------|-----|-----|----|----|-----|----|-----|
| KCC-07 | 540 | 390 | 21 | 50 | 340 | 15 | 525 |
| KCC-08 | 540 | 540 | 21 | 50 | 490 | 15 | 525 |
| KCC-09 | 690 | 390 | 21 | 50 | 340 | 15 | 675 |
| KCC-10 | 690 | 540 | 21 | 50 | 490 | 15 | 675 |
| KCC-11 | 690 | 690 | 21 | 50 | 640 | 15 | 675 |
| KCC-12 | 940 | 440 | 21 | 50 | 390 | 15 | 925 |
| KCC-13 | 940 | 690 | 21 | 50 | 640 | 15 | 925 |
| KCC-14 | 940 | 940 | 21 | 50 | 890 | 15 | 925 |

NOTE: ALL DIMS ARE IN mm WITH A TOLARENCE +/- 2mm

Lasnek

Lasnek, 1 President Way, Luton, Bedfordshire LU2 9NR
Tel: +44 (0) 1582 425777 • Fax: +44 (0) 1582 425776

email: sales@lasnek.com www.lasnek.com