

Lasnek

STAINLESS STEEL PITCH TOP COMPACT ENCLOSURES



- Stainless Grade 304 / 1.4301
- Material Thickness 1.2/1.5mm
- Satin Brush Finish
- Integral 15° Rain Canopy
- Bespoke Service Available
- IP65
- BS EN60529:1992
- Concealed Hinges
- Galvanized Backplate
- Same Day despatch

PITCH TOP COMPACT ENCLOSURES TECHNICAL DATA

KCC-01-S15 TO KCC-05-S15 CABINET DIMENSIONS

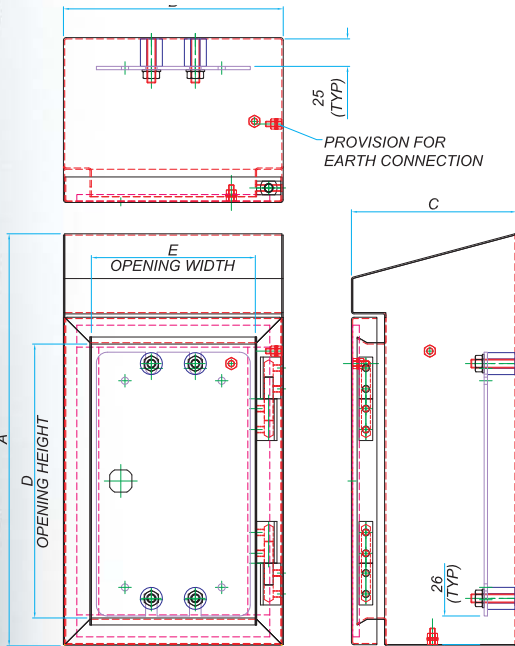

	A	B	C	D	E
KCC-01-S15	375	200	150	249	149
KCC-02-S15	375	300	150	249	249
KCC-03-S15	538	200	200	399	149
KCC-04-S15	538	300	200	399	249
KCC-05-S15	538	450	200	399	399

NOTE: HINGED ON THE RIGHT UNLESS OTHERWISE STATED, CUT OUTS MAY HANG THE ENCLOSURE.
NOTE: ALL DIMS ARE IN mm WITH A TOLERANCE +/- 2mm

KCC-06-S15 TO KCC-14-S15 CABINET DIMENSIONS

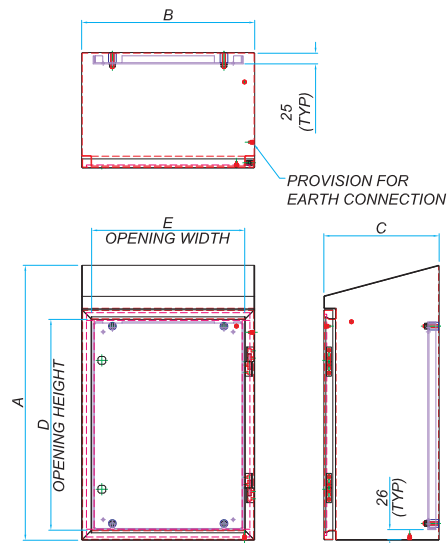

	A	B	C	D	E
KCC-06-S15	715	300	300	548	248
KCC-07-S15	715	450	300	548	398
KCC-08-S15	715	600	300	548	548
KCC-09-S15	865	450	300	698	398
KCC-10-S15	865	600	300	698	548
KCC-11-S15	865	750	300	698	698
KCC-12-S15	1115	500	300	948	448
KCC-13-S15	1115	750	300	948	698
KCC-14-S15	1115	1000	300	948	948

NOTE: HINGED ON THE RIGHT UNLESS OTHERWISE STATED, CUT OUTS MAY HANG THE ENCLOSURE.
NOTE: ALL DIMS ARE IN mm WITH A TOLERANCE +/- 2mm

KCC-01-S15 TO KCC-06-S15 BACKPLATE DIMENSIONS

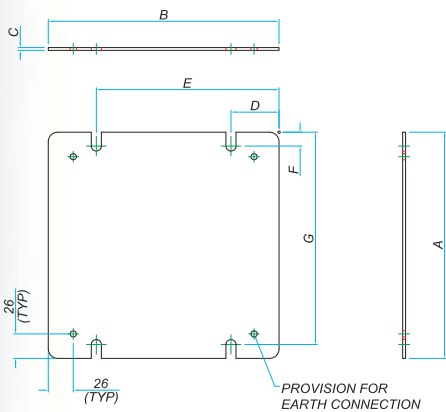

	A	B	C	D	E	F	G
KCC-01-S15	240	140	3	50	90	15	225
KCC-02-S15	240	240	3	50	190	15	225
KCC-03-S15	390	140	3	50	90	15	375
KCC-04-S15	390	240	3	50	190	15	375
KCC-05-S15	390	390	3	50	340	15	375
KCC-06-S15	540	240	3	50	190	15	525

NOTE: ALL DIMS ARE IN mm WITH A TOLERANCE +/- 2mm

KCC-07-S15 TO KCC-14-S15 BACKPLATE DIMENSIONS

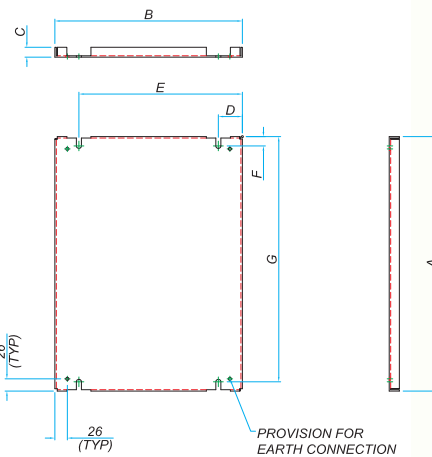

	A	B	C	D	E	F	G
KCC-07-S15	540	390	21	50	340	15	525
KCC-08-S15	540	540	21	50	490	15	525
KCC-09-S15	690	390	21	50	340	15	675
KCC-10-S15	690	540	21	50	490	15	675
KCC-11-S15	690	690	21	50	640	15	675
KCC-12-S15	940	440	21	50	390	15	925
KCC-13-S15	940	690	21	50	640	15	925
KCC-14-S15	940	940	21	50	890	15	925

NOTE: ALL DIMS ARE IN mm WITH A TOLERANCE +/- 2mm

Lasnek

Lasnek, 1 President Way, Luton, Bedfordshire LU2 9NR

Tel: +44 (0) 1582 425777 • Fax: +44 (0) 1582 425776

email: sales@lasnek.com www.lasnek.com